

SEASTAR SPORT PLUS TILT HELMS

⚠ WARNING

Use the self-locking fasteners provided **ONLY**; substituting non-self locking fasteners can result in loosening or separation of equipment leading to loss of steering control causing property damage and/or personal injury.

Installation Instructions

NOTICE

*If the helm pump shaft is difficult to locate into the tilt mechanism coupling, loosen the TOP screw in the coupling by **NO MORE** than 1/4 of a turn. Ensure that this screw is fully tightened before installing the bezels.*

NOTICE

Ensure that tilt latch boot (Item 10) is properly fitted into the slots provided in the lower bezel.

- 1 Using the template provided on Page 5 of the Installation Manual included with the helm pump, confirm that the location of the helm will allow unrestricted operation of the steering wheel in **ALL** tilting positions and will **NOT** interfere with any other functional equipment.
- 2 Tape the template to the dash and use a center punch for locating the holes on the dash. Double check to ensure unrestricted operation of the steering wheel in **ALL** tilting positions.
- 3 Drill required diameter center hole and the specified number and size of the mounting bolts as shown in the template.
- 4 Mount Tilt plate (Item 1) to the dash using the three 1/4" NC x 2" carriage bolts (Item 2, washers (Item 3) and self locking nuts (item 4). Torque to 110 in/lb.
- 5 Prior to mounting the helm pump to the dash plate, install desired fittings into the rear of the helm pump using a Teflon Based pipe sealant. **DO NOT** use Teflon tape, **ONLY** use a paste style Teflon based pipe sealant.
- 6 Mount the helm pump from behind the dash to the tilt mounting plate (Item 1) so that the four helm mounting holes align with the applicable holes in the tilt mount plate. Install the four 1/4" x 2-1/2" hex head bolts (Item 5) and secure them to the helm pump. Torque to 110 in/lb.
- 7 Attach the helm shaft to the tilt mechanism (Item 6) by lining up the coupling slot with the helm shaft tongue and secure with the one 10-24 NC x 7/8" bolt (Item 7). Torque to 20-24 in/lb.
- 8 Install and tighten the two PHMS 5/16" NC x 3/4" screws (Item 8) and the star washers (Item 9) to secure the tilt mechanism to the dash plate. Torque to 160-180 in/lb.
- 9 Install the boot latch (Item 10) onto the tilt latch of the tilt mechanism.
- 10 Fit the upper bezel (Item 11) into the lower bezel (Item 12) and position two parts over the tilt mechanism. Install the 5 x BHSCS 8-32 x 1/2" SS (Item 13) screws into the position show.
- 11 Grease steering shaft with good quality marine grade grease.
- 12 Install the woodruff key (Item 14) and wheel shaft nut (Item 15), Tighten steering wheel shaft nut prior to continuing with installation instructions. Torque wheel shaft nut to 150 in/lb. **DO NOT** exceed 200 in/lb.
- 13 Confirm proper function of the tilt mechanism using the following points.
Push tilt latch forward to 'unlock' the tilt mechanism.
Check **ALL** positions of the tilt and confirm that the latch 'locks' in place for each position, tilt lever will click back into the locked position.

SEASTAR SPORT PLUS TILT HELMS

Installation Instructions (cont.)

14 ONLY if the tilting function is confirmed to function, continue with the 'Remote Fill and Vent Installation' as shown in the installation manual included with the helm pump.

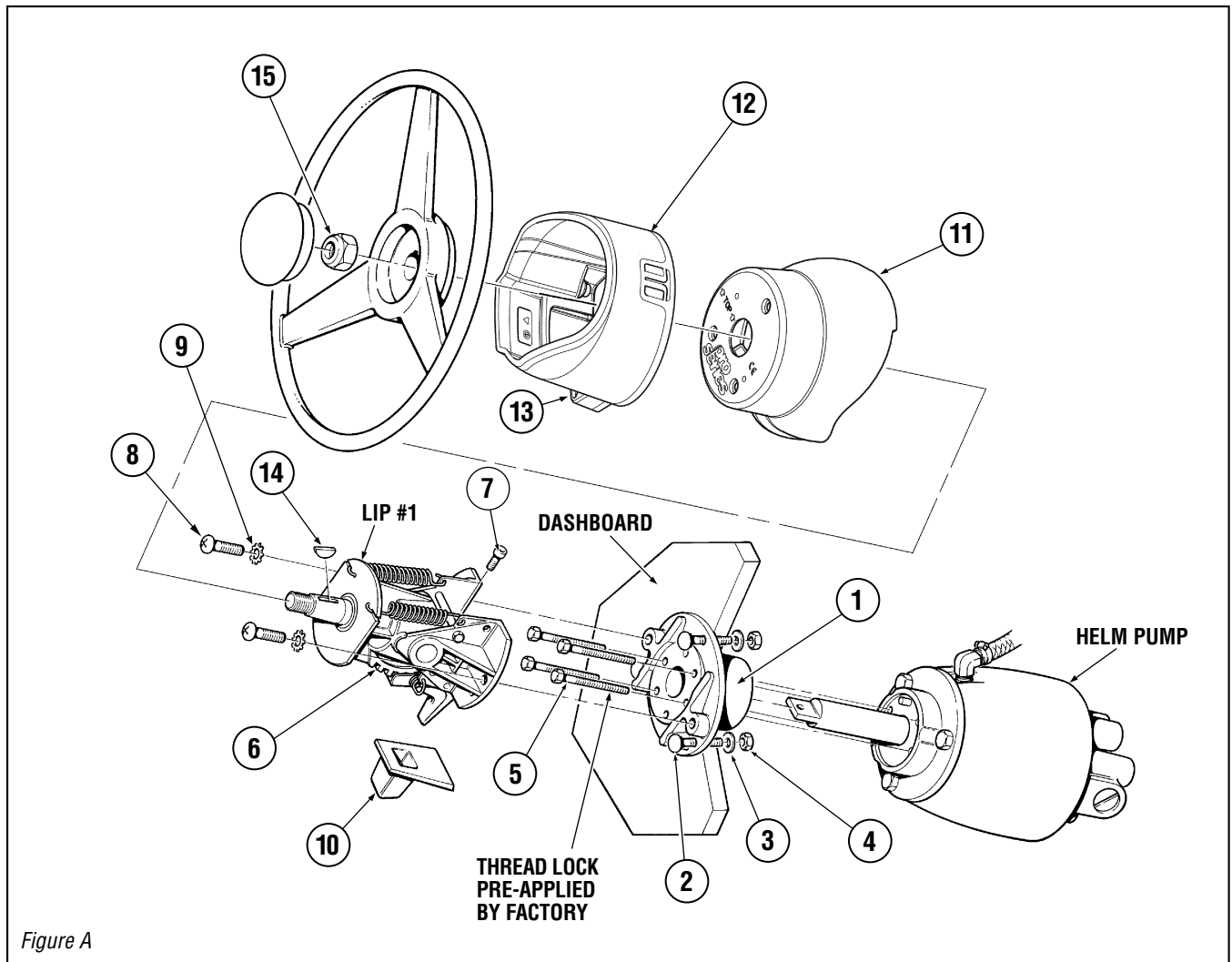

Figure A

ITEM	PART #	QTY	DESCRIPTION
1	279064	1	Tilt Plate
2	984829	3	CB 1/4" NC x 2"
3	201429	3	Washer 1/4" Flat SS
4	067424	3	Nut, 1/4" NC, NYLOC
5	007279	4	HHCS 1/4" NC x 2-1/2" SS
6	182110	1	Tilt Mechanism
7	757927	1	SCHS #10-24 x 7/8" SS
8	958627	2	PHMS 5/16" NC x 3/4"

ITEM	PART #	QTY	DESCRIPTION
9	957725	2	Washer, Star
10	279049	1	Latch Boot
11	279041	1	Upper Bezel
12	279045	1	Lower Bezel
13	279082	5	BHSCS 8-32 x 1/2" SS
14	260130	1	Shaft Key
15	747521	1	Wheel Shaft Nut