

REMOVAL/INSTALLATION OF SEASTAR POWER ASSIST COUPLING

Removal

⚠ CAUTION

Ensure that the Power Assist Pump is turned OFF.

- 1 DO NOT disconnect the motor electrical connections, steering lines, or remove the rear cover enclosure from the power assist unit during the removal and/or installation of the new coupling.
- 2 Locate and loosen the two 5/16" hex head screws from the top of the motor being sure not to misplace the two o-rings that are on the bottom of the motor. (Refer to figure A.)
- 3 Remove and discard coupling located in the valve body (see figure A).

Installation

NOTICE

Ensure that the coupling is fully seated on the gear pack shaft. In some cases you will need to turn and push down to ensure the coupling is fully seated.

NOTICE

Seating the motor incorrectly will cause the Power Assist Unit to malfunction.

- 1 Install new coupling into valve body with the smaller of the two slots facing down.
- 2 Confirm that the 2 x o-rings are installed on the motor prior to installation.
- 3 Position motor so that the power assist identification label is facing outwards (see figure A).
- 4 Line-up the motor shaft to match the same position of the new coupling located in the valve body; ensure motor is correctly seated in place.
- 5 Tighten the 2 x 5/16" hex head bolts and torque to 14 in.lb. MAX.
- 6 Confirm proper operation of the Power Assist by taking your steering wheel hard over to hard over several times with the Power Assist Pump ON.
- 7 If Power Assist does not provide power assist, please contact Teleflex Technical support at the contacts noted below.

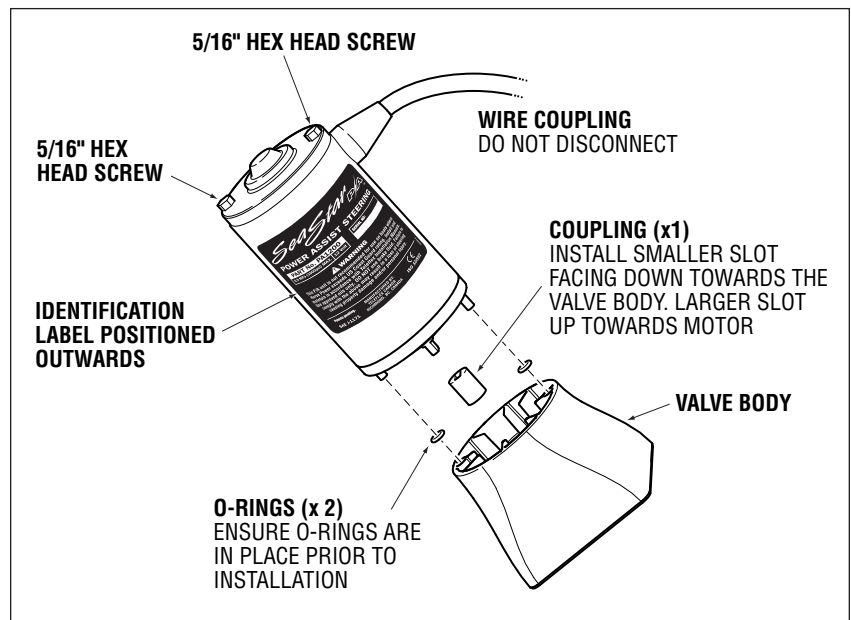

Figure A.